

# SANITARY WARE SPECIFICATION SHEET

Note:  YouTube (Grohe 3282500E) <https://www.youtube.com/watch?v=DYOb8ANyO-c>  
 YouTube (Grohe 3282500E) <https://www.youtube.com/watch?v=DZVopga1tEs>

\* All information of the above is for the reference only. No prior notice is made if any changes.



PROJECT		REF		REV	ITEM CODE	
LOCATION		DATE			PAGE	

## SANITARY WARE SPECIFICATION SHEET

### GROHE EUROSMART COSMOPOLITAN

#### MORE THAN MERE MINIMALISM

Focus on the essential. Eurosmart Cosmopolitan deliberately avoids anything superfluous. The design story of this line of fittings speaks to fans of contemporary architecture, combining modern aesthetics with excellent ergonomics and the highest functionality. The extensive Eurosmart Cosmopolitan line boasts six different faucet models for the washbasin, each brilliantly complementing GROHE ceramics. Whether a fixed, swivel-mounted or electronic cast spout, each model guarantees the highest GROHE quality and optimum ease of use. Our proven technologies, including GROHE SilkMove, GROHE SilkMove ES and GROHE StarLight, are committed to fulfilling our quality promise.



#### GROHE SilkMove cartridge technology for smooth handling

This premium tap comes with a continuously variable water temperature and volume adjustment technology, ensuring effortless lever operation even after years of use.



#### Easy to clean thanks to the GROHE StarLight chrome coating

Just wipe the tap down with a dry cloth – the ultra smooth surface finish is scratch resistant and ensures a lasting luminous sheen. You'll save plenty of time cleaning while your tap always looks shiny and new.



**Standard bathroom spout height**  
That's practical and comfortable

**Pop-up action**  
Lets you open and close waste simply



**EcoJoy technology**  
Reduces water consumption by up to 50%

**Quick and easy installation**

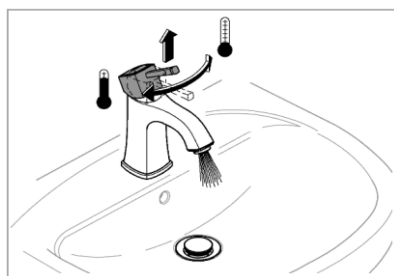
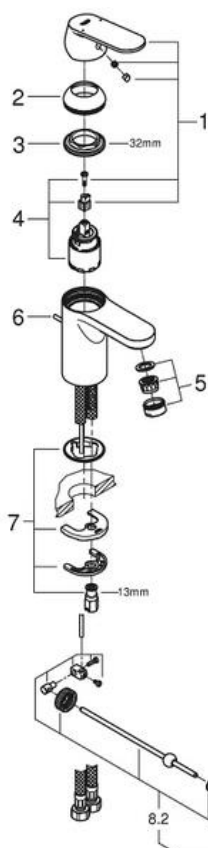

Pos.-nr.	Prod. description	Order-nr.
1	Lever	46681000
2	Cap	46492000
3	Screw coupling	46460000
4	Cartridge	46374000
5	Laminar flow straightener	13955000
6	Pop-up rod	46739000
7	Shank fastening assembly	46671000
8	Waste set 1 1/4"	28910000
9	Mounting wrench	19017000*
10	Socket spanner	19332000*
11	Ball rod	07341000*

\* Optional accessories

Note:

\* All information of the above is for the reference only. No prior notice is made if any changes.



自願參與用水效益標籤計劃 - 水龍頭  
Voluntary Water Efficiency Labelling Scheme - Water Taps



茲證明  
This is to certify that

將下列水龍頭在本計劃內註冊：  
has registered the following water tap under this scheme :

牌子 / Brand	:	Grohe
型號 / Model	:	32825XXE + 64647040
種類 / Type	:	Mixing
原產地 / Country or Region Origin	:	Thailand (Mixer) Germany (Flow Controller)

XX – denotes the code of colour

在用水效益標籤上展示的標誌 <i>Symbolic Presentation on the Water Efficiency Label</i>	:		滴水點 <i>Water droplet(s)</i>
用水效益級別 <i>Water Efficiency Grade</i>	:	1	
耗水量 <i>Water Consumption</i>	:	4.8	公升/分鐘 <i>litres/minute</i>

簽發日期：  
Date of Issue: 22 March 2021

 水務署  
Water Supplies Department



水務署署長(張業駒代行)  
for Director of Water Supplies





水務署  
Water Supplies Department



本署檔  
Our ref.  
來函檔號  
Your ref.

Headquarters  
士打道七號入境事務大樓 48 樓  
on Tower, 7 Gloucester Road, Wan Chai, Hong Kong

321/2020 T/J(1198/2020)

電話 :  
Tel.  
傳真 : 2824 0578  
Fax.

26 November 2020



**Approval of "GROHE" Basin Mixer  
(General Acceptance No. C20201065)**

Your letters ref. WRC/2343, C-WSD/0649 and C-WSD/0672 dated 4 September 2020, 14 October 2020 and 10 November 2020 respectively refer.

Having considered the test report ref. J24988Ar2 issued on 30 October 2020 by Nutek Systems (HK) Ltd., this Authority accepts that the fitting described below complies with, and its use when correctly installed does not contravene, the Waterworks Ordinance and Regulations.

**Name of Manufacturer:** Grohe AG

**Country of Origin:** Thailand

**Brand:** Grohe

**Details of Fitting:** 3/8" Single lever basin mixer

**Model:** 32825XXE  
(where the digits "XX" denote the code of colour)

**Body Markings:** **GROHE**

**Expiry Date:** 12 January 2025



This Authority hereby permits the use of the above fitting in fresh water plumbing systems subject to full adherence to Waterworks installation requirements. In particular, you are required to draw your customers' attention to the following requirement-

"The cold water supply to the fitting shall be drawn from the same source that supplies the hot water apparatus so as to provide a balanced pressure and to obviate the risk of scalding in the event of a restriction or failure in the water supply."

A condition of this acceptance is that the fitting to be installed shall be replicas of the sample as certified by the testing agent mentioned above and without modifications. This acceptance may be withdrawn at any time if the standard of the fitting installed fails to meet that of the approved sample or if the fitting is found to be unsuitable for use in fresh water plumbing systems.

This acceptance is only applicable to the main body of the fitting, unless otherwise specified.

For the use of the fitting in any project, the General Acceptance Number of this letter must be quoted as a means of identification of acceptance of the fitting by this Authority.

Should you have any enquiries, please contact our Engineer Mr. Terry KUNG at tel. no. 3583 4086.

Yours faithfully,



(CHAN Chung-kun)

for Director of Water Supplies

Encl.

c.c.      WSD 3321/1/82    ] - without catalogue  
            ME/MC            ] - with soft copy only